

快装制作要求

材质：双胶纸100g

尺寸：展开尺寸525*297mm

折叠方式：先竖向风琴折4折，再横向对折，折叠后料号、料号二维码页面朝上

颜色：彩色单面

其他：料号后-X，X为供应商缩写

环保要求：满足RoHS和REACH

质量要求：保证印刷清晰，产品无脏污，折叠整齐

Quick Installation Guide

Models:

Avocado 22 Pro-M

Avocado 22 Pro-E

1. Tools Required

The following tools will be required to install battery only (Use Avocado 22 Pro-M and Avocado 22 Pro-E stacked).



2. Packing List

For Avocado 22 Pro-M:

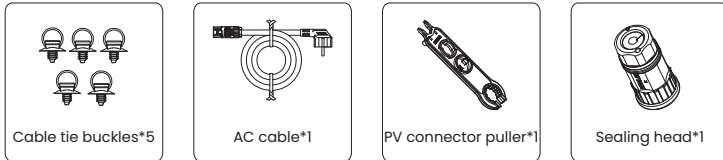

For Avocado 22 Pro-E:

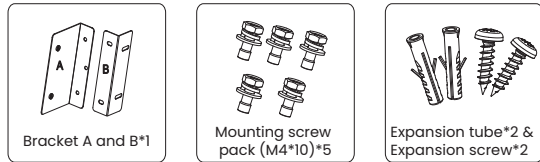

3. Product Overview

For Avocado 22 Pro-M:

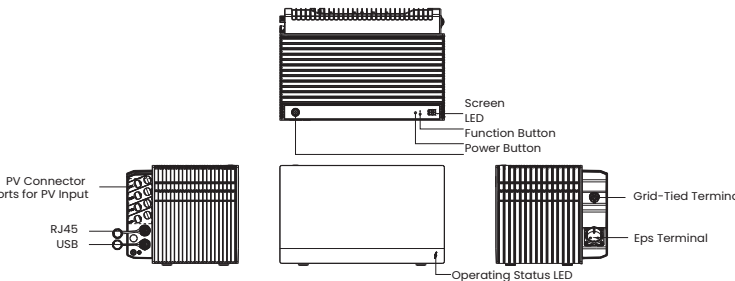

For Avocado 22 Pro-E:

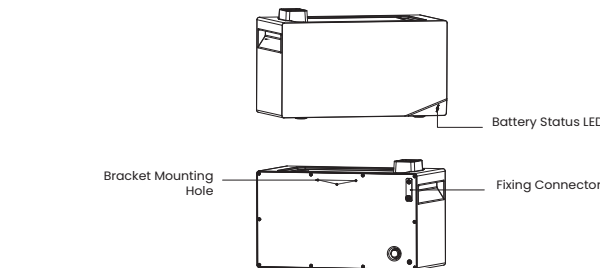

4. Installation Steps

Scenario

The steps below describe the installation of one Avocado 22 Pro with four solar panels as an example.

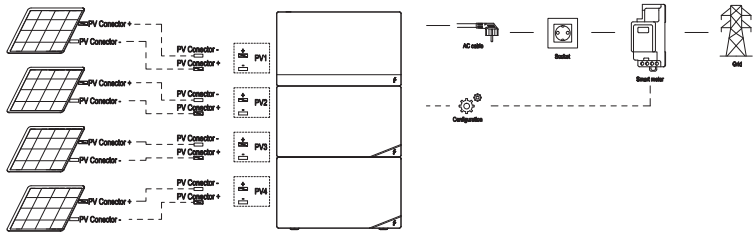

Step 1

Install the dust covers of the bottom Avocado 22 Pro-E and remove the other dust covers.

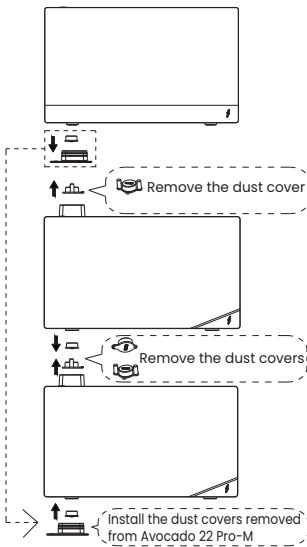

Step 2

Lock bracket A to the rear cover of the battery with screws (M4*10).

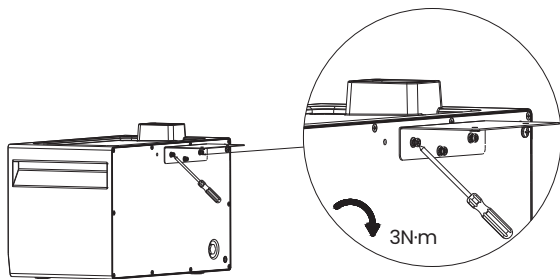

Step 3

Lock bracket B to bracket A and move the battery to a suitable position against the wall and mark the bracket holes on the wall with a marker.

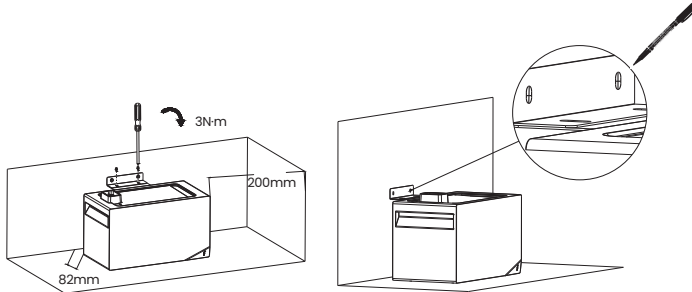

Step 4

Note: Remove the battery before drilling.

Drill φ8*40mm or deeper holes at the two markers, hammer the expansion tubes into the holes, and then use a screwdriver to fasten the two M6*40 expansion screws to the bracket B.

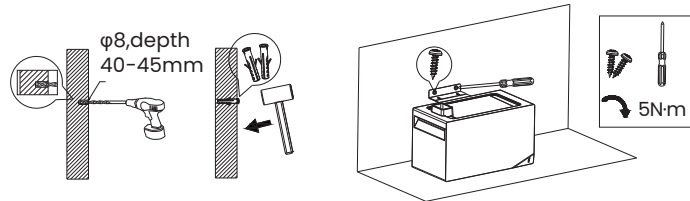

Step 5

Install the required stacked battery in the orientation shown in the figure.

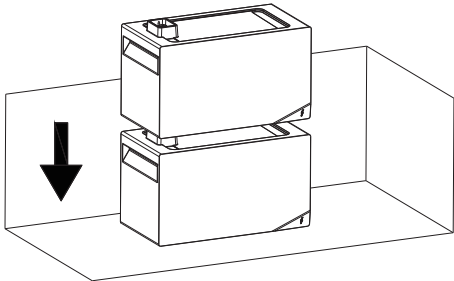

Step 6

Rotate the fixing connector to the corresponding hole of the upper battery and tighten the screw to fix it.

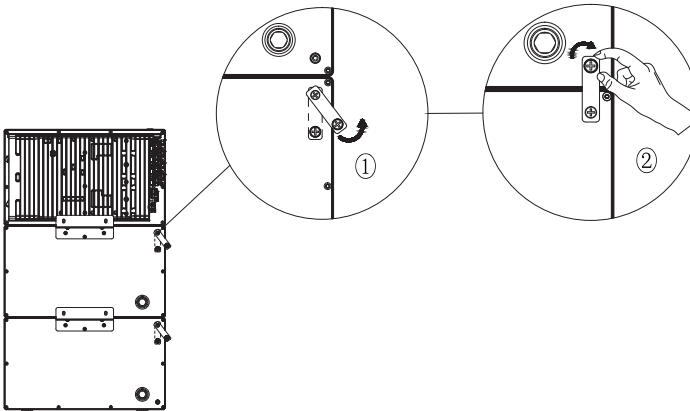

Note: Ensure that each system has only one unit of Avocado 22 Pro-M and a maximum of four units of Avocado 22 Pro-E.

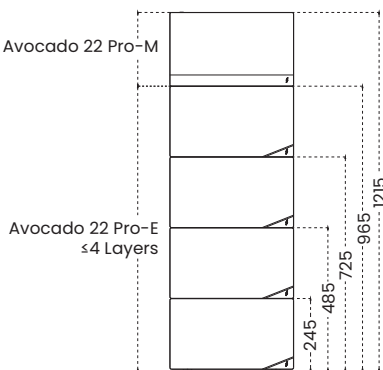

5. Electrical Connections

1. Connect Avocado 22 Pro to a home outlet using the included AC Cable.

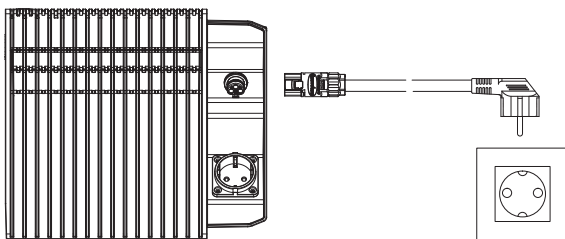

2. Find the PV connector ports of your solar panels.

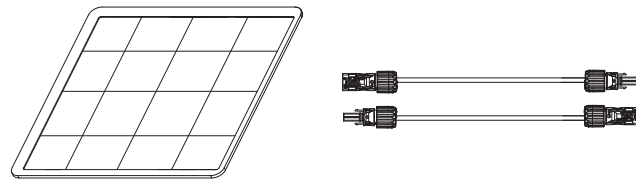

3. Connect each PV module directly to the same set of PV input ports.

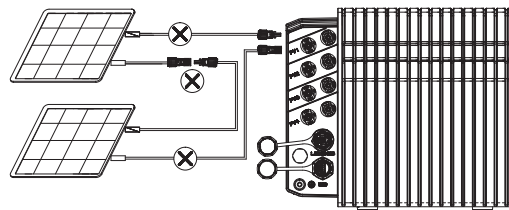
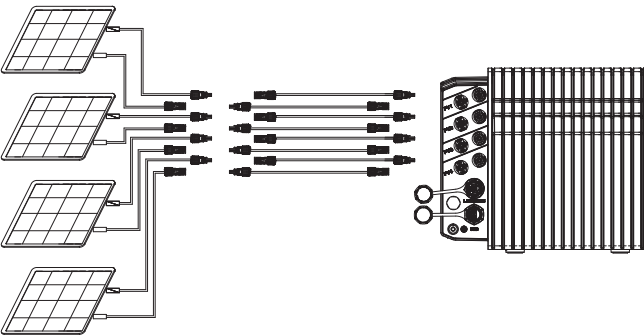

Note: Never connect two or more components in series because this causes the input voltage to exceed 60V and will damage the equipment.

4. If you want to disconnect the PV connector: After ensuring the system is turned off, use the included wrench to safely remove the PV connector.

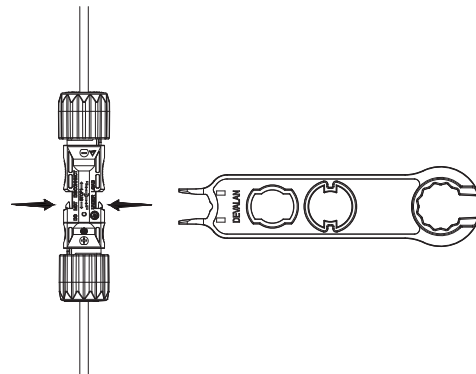

6. System Operation

All installation and operation must comply with local electrical standards. Check all power cables carefully.

Button	Action	Function
	Press for 2 Seconds (in power off state)	Turn on the battery
	Press for 2 Seconds (in power on state)	Enable/disable EPS output
	Press for 5 Seconds (in power on state)	Turn off the battery
	Press for 2 Seconds (in screen off state)	Light up the screen
	Press for 2 Seconds (in screen on state)	Switch the screen page
	Press for 20 Seconds	Reset bluetooth and Wi-Fi

7. APP Configuration

Download the app compatible with your system.



Scan the QR code below to read the configuration guide.



8. Smart Meter Configuration

Please scan the QR code below to get the latest supported smart meters and specific configuration methods for various models of smart meters.



9. User Manual

Please scan the QR Code and follow the steps below to download our latest multi-language User Manual/Quick Installation Guide:
Scan the QR Code → Select your Language → Choose to download User Manual or Quick Installation Guide → Download

